

**CHAIN-LINK FENCES  
BID SPECIFICATIONS**

**DESCRIPTION**

- 1** This item shall consist of furnishing and erecting Chain-Link fence in accordance with these specifications and the details shown on the plans and in conformity with the lines and grades shown on plans or established by the Engineer. Contractor shall submit shop drawings on all fencing and gates.

**MATERIALS**

- 2 FABRIC.** The fabric shall be woven with a 9-gauge galvanized steel wire in a 2-inch mesh and shall meet the requirements of galvanized steel fabric and conform to the requirements of ASTM A 392, Class 2.
- 3 BARBED WIRE.** Barbed wire shall be 2-strand 12-1/2 gauge zinc-coated wire with 4-point barbs and shall conform to the requirements of zinc-coated barbed wire shall conform to the requirements of ASTM A 121, Class 3, Chain-Link Fence Grade.
- 4 POSTS, RAILS AND BRACES.** Line posts, rails, and braces shall conform to the requirements of AST- F-1043 or ASTM F 1083 as follows:

Galvanized tubular steel pipe shall conform to the requirements of Group IA, (Schedule 40) coatings conforming to Type A, or Group IC (High Strength Pipe), External coating Type B, and internal coating Type B or D.

Posts, rails, and braces furnished for use in conjunction with aluminum alloy fabric shall be aluminum alloy or composite.

Posts, rails, and braces, with the exception of galvanized steel conforming to F 1043 or ASTM F 1083, Group 1A, Type A, or aluminum alloy, shall demonstrate the ability to withstand testing in salt spray in accordance with ASTM B 117 as follows:

External: 1,000 hours with a maximum of 5% red rust

Internal: 650 hours with a maximum of 5% red rust.

The dimensions of the posts, rails, and braces shall be in accordance with Tables 1 through VI of Fed. Spec. RR-F-191/3D.

Where called for, reflective tape is to be placed completely around posts (top, middle, and bottom). Tape shall be Scotchlite (or approved equal) Reflective Conspicuity Marking, 11-inch red and 7-inch white meeting ASTM D4956-93B Type V and NHTSA conspicuity regulation: LS300-CFP92. Tape is to be considered incidental to the project.

- 5 GATES.** Gate frames shall consist of galvanized tubular steel pipe and shall conform to the specifications for the same material under paragraph 162-2.3. The fabric shall be of the same type material as used in the fence.

- 6 WIRE TIES AND TENSION WIRES.** Wire ties for use in conjunction with a given type of fabric shall be of the same material and coating weight identified with the fabric type. Tension wire shall be 7-gauge marcelled steel wire with the same coating as the fabric type and shall conform to ASTM A 824.

All material shall conform to Fed. Spec. RR-F-191/4D

- 7 MISCELLANEOUS FITTINGS AND HARDWARE.** Miscellaneous steel fittings and hardware for use with zinc-coated steel fabric shall be of commercial grade steel or better quality, wrought or cast as appropriate to the article, and sufficient in strength to provide a balanced design when used in conjunction with fabric posts, and wires of the quality specified herein. Barbed wire support arms shall withstand a load of 50 pounds (113 kg) applied vertically to the outermost end of the arm.
- 8 CONCRETE.** Concrete shall be of a commercial grade with a minimum 28-day compressive strength of 2500 psi (17 240 kPa).
- 9 MARKING.** Each roll of fabric shall carry a tag showing the kind of base metal (steel, aluminum, or aluminum alloy number), kind of coating, the gauge of the wire, the length of fencing in the roll, and the name of the manufacturer. Posts, wire, and other fittings shall be identified as to manufacturer, kind of base metal (Steel, aluminum, or aluminum alloy number), and kind of coating.

#### **CONSTRUCTION METHODS**

- 10 CLEARING FENCE LINE.** All trees, brush, stumps, logs, and other debris which would interfere with the proper construction of the fence in the required location shall be removed a minimum width of 2 feet (61 cm) on each side of the fence centerline before starting fencing operations. The cost of removing and disposing of the material shall not constitute a pay item and shall be considered incidental to fence construction.
- 11 INSTALLING POSTS.** All posts shall be set in concrete at the required dimension and depth and at the spacing shown on the plans.

Posts should be spaced not more than 10 feet (3 m) apart and should be set a minimum of 36 inches (90 cm) in concrete footings. If the frost depth is greater than 36 inches (90 cm), the posts should be set accordingly. The posts holes shall be in proper alignment so that there is a minimum of 3 inches (75 mm) of concrete on all sides of the posts.

The concrete shall be thoroughly compacted around the posts by tamping or vibrating and shall have a smooth finish slightly higher than the ground and sloped to drain away from the posts. All posts shall be set plumb and to the required grade and alignment. No materials shall be installed on the posts, nor shall the posts be disturbed in any manner within 7 days after the individual post footing is completed.

Should rock be encountered at a depth less than the planned footing depth, a hole 2 inches (50 mm) larger than the greatest dimension of the posts shall be drilled to a depth of 12 inches (300 mm). After the posts are set, the remainder of the drilled hole shall be filled with grout,

composed of one part Portland cement and two parts mortar sand. Any remaining space above the rock shall be filled with concrete in the manner described above.

In lieu of drilling, the rock may be excavated to the required footing depth. No extra compensation shall be made for rock excavation.

**12 INSTALLING TOP RAILS.** The top rail shall be continuous and shall pass through the post tops. The coupling used to join the top rail lengths shall allow for expansion.

**13 INSTALLING BRACES.** Horizontal brace rails, with diagonal truss rods and turnbuckles, shall be installed at all terminal posts.

**14 INSTALLING FABRIC.** The wire fabric shall be firmly attached to the posts and braced in the manner shown on the plans. All wire shall be stretched taut and shall be installed to the required elevations. The fence shall generally follow the contour of the ground, with the bottom of the fence fabric no less than 1 inch (25 mm) or more than 4 inches (100mm) from the ground surface. Grading shall be performed where necessary to provide a neat appearance.

At locations of small natural swales or drainage ditches and where it is not practical to have the fence conform to the general contour of the ground surface, longer posts may be used and multiple strands of barbed wire stretched thereon to span the opening below the fence. The vertical clearance between strands of barbed wire shall be 6 inches (150 mm) or less.

**15 ELECTRICAL GROUNDS.** Electrical grounds shall be constructed where a power line passes over the fence and at 500-foot (150 m) intervals. The ground shall be installed directly below the point of crossing. The ground shall be accomplished with a copper clad rod 8 feet (240 cm) long and a minimum of 5/8 inch (15 mm) in diameter driven vertically until the top is 6 inches (150 mm) below the ground surface. A No. 6 solid copper conductor shall be clamped to the rod and to the fence in such a manner that each element of the fence is grounded. Installation of ground rods shall not constitute a pay item and shall be considered incidental to fence construction.

#### **BASIS OF PAYMENT**

**16** Payment will be made at the contract bid price. The price shall be full compensation for furnishing all materials, and for all preparation, erection, and installation of these materials, and for all labor equipment, tools, and incidentals necessary to complete the item.

#### **MATERIAL REQUIREMENTS**

ASTM A 121	Zinc-coated (Galvanized) Steel Barbed Wire
ASTM A 123	Zinc (Hot Galvanized) Coatings on Products Fabricated from Rolled, Pressed, and forged Steel Shapes, Plates, Bars, and Strip
ASTM A 153	Zinc Coating (Hot-Dip) on Iron and Steel Hardware
ASTM A 392	Zinc-Coated Steel Chain-Link Fence Fabric

ASTM A 446	Specification for Steel Sheet, Zinc-Coated (Galvanized) by the Hot-Dip Process, Structural (Physical) Quality
ASTM A 491	Aluminum-Coated Steel Chain-Link Fence
ASTM A 569	Steel, Carbon (0.15 Maximum, Percent), Hot Rolled Sheet and Strip Commercial Quality
ASTM A 570	Hot-Rolled Carbon Steel Sheet and Strip Structural Quality
ASTM A 572	High-Strength Low-Alloy Columbium-Vanadium Steels of Structural Quality
ASTM A 585	Aluminum-Coated Steel Barbed Wire
ASTM F 668	Poly (Vinyl Chloride)(PVC)-Coated Steel Chain-Link Fence
ASTM F 1043	Strength and Protective Coatings on Metal Industrial Chain-Link Fence Framework
ASTM F 1083	Pipe, Steel, Hot-Dipped Zinc-Coated (Galvanized) Welded, for Fence Structures
ASTM F 1183	Aluminum Alloy Chain-Link Fence Fabric
ASTM F 1234	Protective Coatings on Steel Framework for Fences
Fed. Spec.	Fencing, Wire and Post, Metal (Chain-Link Fence Posts, Top Rails and braces) RR-F-191/3D
Fed. Spec.	Fencing, Wire and Post, Metal (Chain-Link Fence Accessories) RR-F-191/4D

# Lafayette Municipal Airport Fencing Project

1. Erect app. 1775 feet of Chain-Link fence
2. Install one (1) 16 foot gate (location to be determined by owner)
3. Attach new fence to existing fence at the north east and south west junctions

REMAINING HARVEY  
PATTERSON HEIR  
DEFENSE FOR EXISTING DE

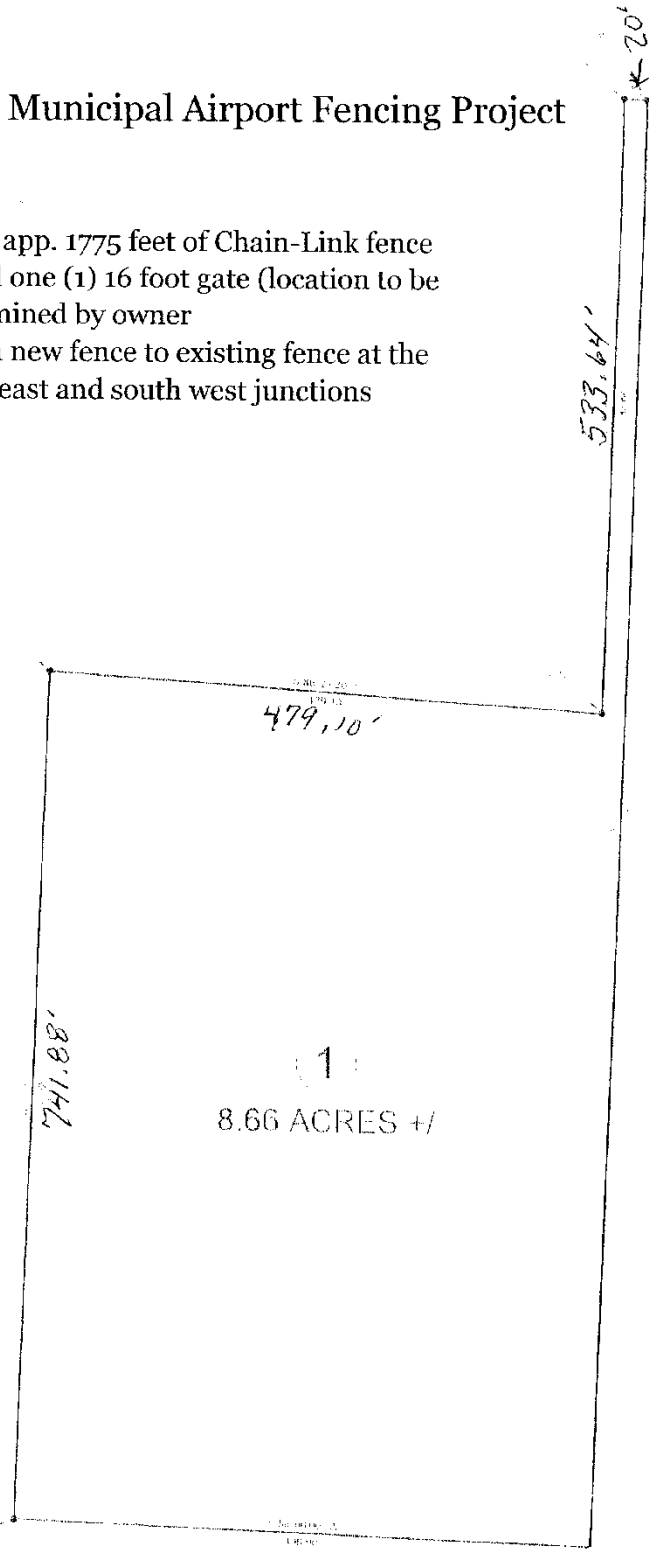

CITY OF LAFAYETTE  
PLANNING DEPARTMENT

**NOTICE TO VENDORS**

**Sealed proposals including vendor name and address will be received by the City of Lafayette, at the office of the City of Lafayette Recorder's Office, 200 East Locust St., Lafayette, TN 37083, the hour 2:00 p.m., on the 6<sup>th</sup>, day of March 2012 at which time proposals duly delivered and submitted.**

Until the final award by the City of Lafayette, said city reserves the right to reject any and/or all proposals, to waive technicalities, to re-advertise, to proceed otherwise when the best interests of the City will be realized hereby. Proposals will be submitted sealed and plainly marked with the date and time of receipt.

The City of Lafayette does not discriminate based on race, color or national origin in federal or state sponsored programs, pursuant to Title VI of the Civil Rights Act of 1964 (42 U.S.C. 2000d).With regard to all aspects of this contract, contractor certifies and warrants it will comply with this policy.

Bidder \_\_\_\_\_ Phone: \_\_\_\_\_

Address: \_\_\_\_\_

Bid : \_\_\_\_\_

**CITY OF LAFAYETTE CONTRACT MONITORING**

TDOT requires that sub-recipients maintain records of those ethnic and gender groups who are awarded bids on projects.

For Title VI compliance, we ask for voluntary disclosure of the following information:

Gender: Male \_\_\_\_\_ Female \_\_\_\_\_

Race: Caucasian \_\_\_\_\_  
African American \_\_\_\_\_  
Hispanic \_\_\_\_\_  
American Indian and Alaskan Native \_\_\_\_  
Native Hawaiian or other Pacific Islander \_\_\_\_\_  
Other (please specify) \_\_\_\_\_